

ALL RIGHTS ARE RESERVED HEREIN BY THE PROPERTY OF GILBERT ENGINEERING CO., INC. ANY REPRODUCTION OR TRANSMISSION OF THIS DRAWING, PARTS OR INFORMATION, OR IN ANY MANNER, OR BY ANY MEANS, WITHOUT THE EXPRESS WRITTEN PERMISSION OF GILBERT ENGINEERING CO., INC. IS PROHIBITED.

REV.	DESCRIPTION	DATE	BY
C	SEE ECO QM-9860	6/7/99	MJC

**MATERIAL AND FINISH**

SHROUD: CRES 303 PER ASTM A 484 AND ASTM A 582 OR ASTM A 555 AND ASTM A 581. PASSIVATE PER MIL-F-14072 E 300.

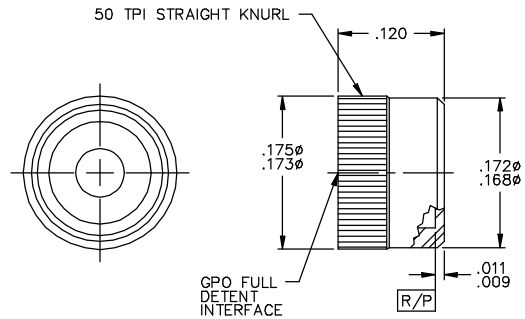

ALL DIMENSIONS ARE IN INCHES

CAT. NO. 0119-949-3

CODE IDENT. NO. 82316

GILBERT ENGINEERING CO., INC.

BY	DATE	TITLE
JRM	7/26/96	OUTLINE DRAWING FOR GPO FULL DETENT PRESS-IN SHROUD
ASSEMBLY PROCEDURES: NONE		
SOURCE FILE: MEOR# 808	SHT. 1 OF 1	DWG. NO. 01-0119-949-3
		REV C